

BRAVURA

# HOSPITALITY



# MODERNFOLD

For decades, Modernfold has been known as the leader for banquet hall space division, but why not utilize the stylish modern systems for private areas in casual and fine dining restaurants. Satisfy a variety of needs from basic sight separation to sight and sound separation with Modernfold's line of durable, high quality space division products.

Client's greatest concerns with folding partitions in hospitality applications

- Product longevity and aesthetics

How using Modernfold overcomes these concerns:

- No vertical trim on solid opaque panels
- Lifetime hinge warranty
- Automatic seals requiring no special tools to operate
- 51 STC glass partitions - Industry Highest!
- White steel track finished to match standard T-bar systems instead of clear anodized aluminum
- Unlimited finish options from fabrics, applied vinyl, to custom millwork





## SKYFOLD

Add another added value feature to your client's facility with a Canadian made horizontal operable wall system. Easy to use and fully automatic, Skyfold partitions offers state-of-the-art acoustics ranging from STC 48 to 60 and innovative partition panels that fold vertically in an accordion style.

Client's greatest concerns with vertically operable walls:

- Acoustics - the ability to book separate events in each divided room

How using Skyfold overcomes these concerns:

- Skyfold offers the highest STC rating for any operable partition system in the world
- Completely customizable finish
- Incredible low maintenance
- Alleviate the workload from porters and other staff with a simple push of a button
- Modular design allows for lower installation cost

## DORMA HUPPE

Easily add refinement with fully automated operable solid and glass partitions with clean lines and endless flexibility in space management.

Client's greatest concerns with automatic horizontal partitions:

- Lack of panel stacking and storing options

How DORMA Hüppe overcomes these concerns:

- Panel stacking locations not tethered to the partition run line
- Ability to store panels in a corner of a room, or another room altogether
- Fire rated systems are available to meet Ontario and Quebec code requirements



# SMOKEGUARD

Fire retardant curtains, sometimes referred to as fire or smoke curtains, are curtains specially designed to keep building occupants safe from both heat and smoke during a fire. While many commercial buildings already utilize fire curtains, a growing number of hospitals and other medical facilities now have these curtains installed for smoke and fire protection.

Client's greatest concerns with fire and smoke door products:

- Housing space & esthetics

How using Smokeguard overcomes these concerns:

- Smaller housing units, with most being between 160mm x 160mm – 225mm x 260mm
- Powder coated white ceiling covers (or select any RAL colour)
- Low profile side guide and jambs



## KALWALL

Kalwall Systems offer glare-free museum-quality daylighting™ and so much more. Perfect for hospitality projects, Kalwall provides impressive thermal performance and solar control while meeting the most demanding code requirements while creating the perfect ambiance.

Client's greatest concerns with fenestration products:

- Cost, thermal performance, and longevity

How using Kalwall overcomes these concerns:

- Lower upfront cost than typical curtain wall systems
- Self cleaning and virtually maintenance free
- Highest insulating daylight system in North America, with up to R20 panels
- Solar heat gain coefficient values typically between 0.15-0.08
- Colour stable, south Florida tested, and designed to be a lifetime building product in Ontario

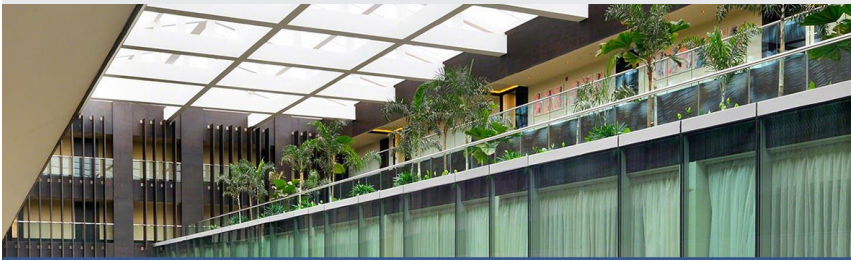
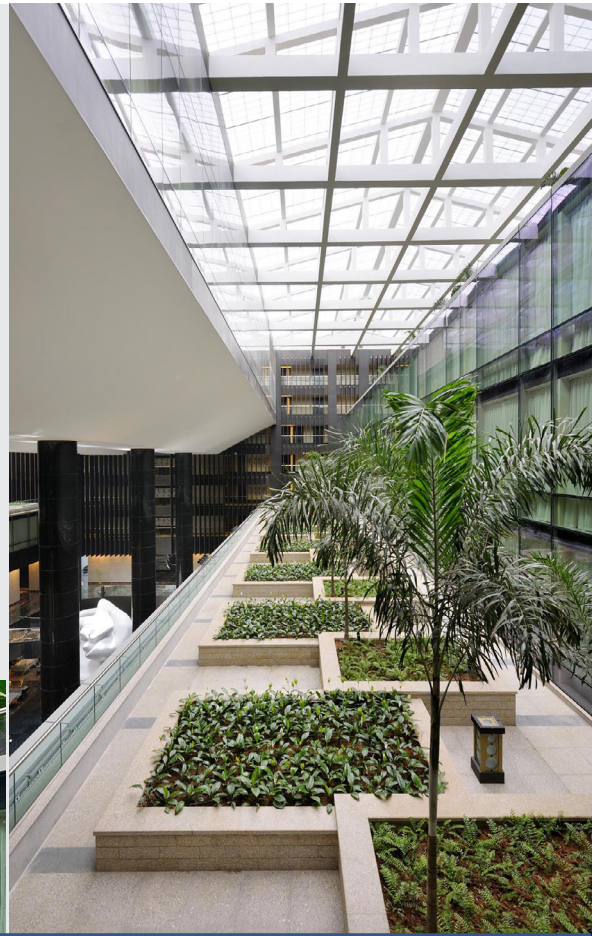

## SOLATUBE

Create the optimal quick service environment with Solatube Tubular Daylight Systems! A cost-effective way to provide innovative optical technologies that balance light output and thermal performance, delivering optimal light levels without uncomfortable heat gain, glare or shifting patterns of light. Solatube's unique design also minimizes impact on the building envelope, allows for easy integration with electrical lighting systems and eliminates ongoing maintenance.

The result is a cost-effective and energy-efficient solution that brings daylight to previously unreachable spaces—like POS stations and the BOH areas, taking care of the wellbeing of both the customers and staff.

Client's greatest concerns with top mounted daylighting products:

- Leaks and condensation, and cost

How using Solatube overcomes these concerns:

- High impact, optically advanced domes which meet DoD Antiterrorism standards and FM rated
- Available fire ratings to meet Ontario and Quebec building codes
- One piece leak-proof & insulated flashing
- FEMA Safe Room rated for Tornadoes and Hurricanes
- Incredibly cost effective



# STRUCTURESUNLIMITED

Create an inviting entrance while mitigating glare and solar heat gain with a StructuresUnlimited fabricated system. StructuresUnlimited has engineered, fabricated, and installed countless canopy and covered walkway designs for the hospitality market for almost 50 years. A single source solution to design, engineer, fabricate, and erect cost-effective entrance canopies and skylights using factory finished, structural aluminum systems clad with Kalwall translucent panel.

Clients greatest concerns with entrance canopies:

- Cost & schedule implications

How using StructuresUnlimited overcomes these concerns:

- Lower total cost of ownership than traditional built-up canopy systems
- Single source from start to finish (no more “finger pointing”)
- Always on-time and on-budget
- Factory finished aluminum framing



## ONTARIO

10 CARLOW CRT #8  
WHITBY, ONTARIO, L1N 5Y9

+1 (800) 803-1235

## QUEBEC

1111 DR. FREDERIK-PHILIPS BOUL  
6TH FLOOR, SAINT-LAURENT  
QUEBEC, H4M 2X6

+1 (514) 600-5995

[www.bravuradesign.com](http://www.bravuradesign.com)

