



GLASS WALL SYSTEMS

Movable Glass Walls

02:52:17 PM RTRS - BRIEF-
02:49:22 PM RTRS - REFLE-FAC T
02:48:28 PM RTRS - BRIEF-Apache Offshor
02:46:58 PM RTRS - BRIEF-As Managing Partner
02:46:25 PM To Withdraw
02:44:06 PM RTRS - VENEZUELAN AUTHORITIES HAVE BE
COUNTRY: INFORMATION MINISTER
RTRS - RPT-VENEZUELA'S MAIN HYDROELECTRIC DAM HAS
INFORMATION MINISTER
RTRS - VENEZUELA'S MAIN HYDROELECTRIC DAM HAS BEEN VICTIM OF A
RTRS - BRIEF-Dominion Energy CEO Thomas Farrell II's FY 2018 Total Compensation
Milion

EXIT





TRANSITION IS CLEAR WITH MODERNFOLD GWS MOVABLE GLASS WALLS

Create an open floor plan and provide natural light with a Modernfold Glass Wall System. Architects and interior designers can include the elegance and confidence of glass in their corporate, retail, and entertainment projects. Standard systems come with clear glass. For custom specifications, you can choose from a variety of options. For your next project, explore the possibilities of clear space division with Modernfold Glass Wall Systems.

- Standard Movable Glass Wall System comes with clear glass
- Standard glass options include frosted, low-iron, and markerboard glass
- Custom glass solutions are available
- Maximum height is 120-inches (3048 mm)
- Maximum panel width is 48-inches (1219 mm)
- Maximum panel weight is 330 pounds (150 kg)



COMFORTDRIVE®

AUTOMATED SELF-DRIVING PANEL SYSTEM

Convenience and automation are two highly desired features of movable walls. The ability to simply press a button and your space is automatically divided into a variety of pre programmed layouts correctly and efficiently every time is what users desire in today's hectic world.

The ComfortDrive® Automated Self-Driving Panel System from Modernfold does just that. Providing outstanding convenience and flexible space utilization

- Fully automatic operation at the push of a button
- Easy operation with user friendly touch pad
- High level of safety ensured by an integrated monitoring system that stops and reverses the panel on contact with an obstacle

with the beauty and daylighting benefits of Compactline® glass panels.

With ComfortDrive®, Compactline® glass panels can be moved to a variety of individually pre-programmed positions under fully automatic control. The control interface takes the form of a user-friendly touch pad which can be programmed to maximize your space in a variety of applications.

- UL® 325 safety-tested and certified
- Panels individually programmable for custom configurations
- Up to 30 panels per partition system



COMPACTLINE® GIVES SLIDING PARTITIONS THE PROFILE THEY NEED

By providing large glazed areas with distinctively curved transitions top and bottom, the Compactline® arc adds harmony to the overall appearance. The door closer is also integrated as a concealed unit for the ultimate in aesthetic perfection.

- Straight line, angled, or segmented configurations
- No visual interruptions due to continuous glass frontage
- Full wall panels with corner and angled panel layout
- Single and double pass doors available
- All working parts are integrated in the profiles creating a seamless look
- Lightweight for ease of operation





PUREVIEW® GLASS WALL SYSTEMS

The PureView® Glass Wall System family features a winning combination of high-quality glass partitions paired with easy and convenient operability in a variety of configurations to fit any space division need.

Featuring both PureView® and PureView® Plus product options, PureView® provides highly-desired daylighting capabilities and space flexibility. PureView® offers multiple layout options, clear, uninterrupted sight-lines, and security through foot-operated interconnecting floor bolts. PureView® Plus combines these highly-desired features with a convertible panel pass door, which provides egress in various layout combinations. Both PureView® and PureView® Plus offer various levels of acoustical control, allowing for the desired look and daylighting of glass with the privacy needs of your space.



PureView® and PureView® Plus are available in a variety of configurations including single panel, paired panel, and continuously hinged panel, which encompasses PureView® FSW-C and PureView® FSW-G.

Designed with attention to every detail, PureView® can be safely and quickly operated, while providing the space management flexibility desired with the modern glass wall aesthetic. The high-quality manufacturing standard of PureView® results in a robust and durable solution that promotes safe and reliable operation. The partition is easy to operate and aligned to the requirements of everyday usage.

PUREVIEW®

- Acoustical control up to **37 STC** on single panel configurations
- Double vinyl top & bottom seals
- Foot operated face & end panel interconnecting floor bolts for security & convenience
- Variety of glass and rail options
- Available in Single Panel, Paired Panel, FSW-C, and FSW-G configurations

PUREVIEW® PLUS

- Acoustical control up to **37 STC** on single panel configurations
- Convertible pass door panel for variable egress
- Concealed pass door closer
- Variety of door pull options
- Double vinyl top & bottom seals
- Foot operated face & end panel interconnecting floor bolts for security & convenience
- Variety of glass and rail options
- Available in Single Panel, Paired Panel, FSW-C, and FSW-G configurations

PUREVIEW® CONFIGURATIONS

SINGLE PANEL

PureView® single panels provide quick and efficient operation for a wide variety of layout options. Moving on dual pre-programmed carriers incorporated into Modernfold Smart Track™ technology allows for easy operation in straight-line or remote storage locations.

PureView® single panels also provide highly desired acoustical control with the fully framed option. PureView® single panels offer acoustical values of **15, 33, 35, and 37 STC** to allow for the benefits of daylighting, while also creating the highly desired acoustical control.

PAIRED PANEL

PureView® Paired Panels are ideal for straight-line openings that require both space division and daylighting. Panels are hinged together in sets of two, which allow for a quick and efficient set-up when flexible space division is needed. Users will enjoy the ease of operation paired with the continuous, transparent appearance of glass in their space.



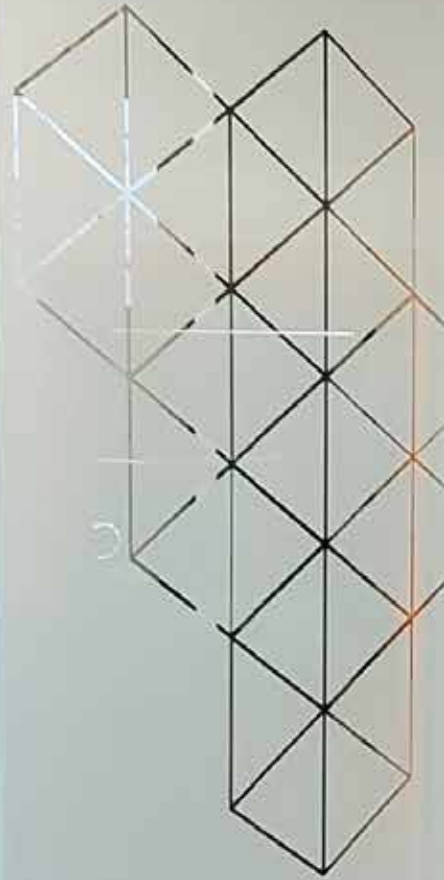





PureView® FSW-G

PUREVIEW® GLASS WALL SYSTEM

FOLDING SLIDING WALLS

Modernfold Folding Sliding Walls (FSW) are ideal for a straight-line system configuration. Because the panels of an FSW system are visually compatible with the PureView® panels, both system types can use the same track and rail construction and can be effectively combined within a single frontage. Consequently, an FSW system can also be complemented by adding a free-standing PureView® double action end panel to allow for egress.

Whether for an airport retail storefront or a dividing wall for an office conference area, PureView® Folding Sliding Wall Systems (FSW-C / FSW-G) are ideal for any application that requires total vision. Glass walls transcend the limitations of fixed solid walls, multiply your options for designing space, and allow daylight to shine through to interior spaces. FSW sliding walls are available in a range of customizable systems to meet your design requirements.



FSW-C

- Frameless folding center pivoting sliding wall system ideal for straight-line openings
- Fixed lead panel for egress
- Continuously hinged for quick and efficient set-up
- Continuous, transparent surface without any vertical trim
- No floor track
- Variety of glass and rail finish options

FSW-G

- Frameless folding sliding wall system ideal for straight-line openings
- Perpendicular folding and stacking
- Fixed lead panel for egress
- Continuously hinged for quick and efficient set-up
- Continuous, transparent surface without any vertical trim
- No floor track
- Variety of glass and rail finish options





INNOVATION AND QUALITY MADE EASY WITH GWS-DRS RAIL SYSTEM

Innovative design, quality materials, and the finest workmanship mean that DRS rails have the features that meet the most demanding conditions. The DRS system offers dry glaze sidelite rails to match door profiles, plus a complete range of bottom rails to meet ADA requirements. This system is available with either a sliding panel closure or a pivot panel closure. Optional floor or ceiling closer and handles allow a pivot panel closure to be used as a pass door.

- On-site size adjustability and glass replacement
- Snap-on covers
- Glass thickness of 1/2-inch (13 mm)
- Standard maximum height 120-inches (3048 mm)
- Standard maximum width 48-inches (1219 mm)
- 1-year warranty

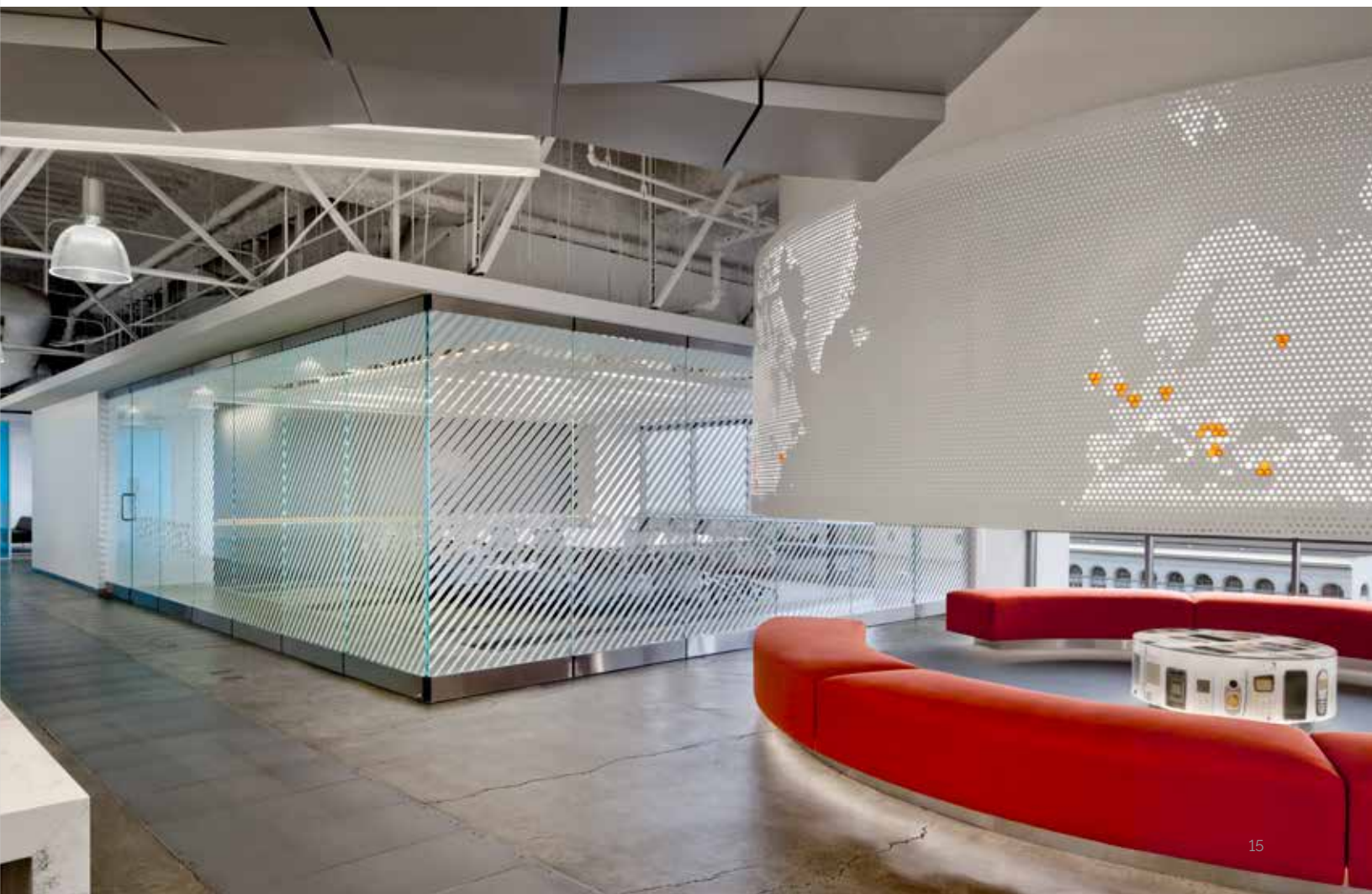

IMMERSE YOUR SPACE IN LIGHT WITH HSW-GP SYSTEMS

The characteristic features of HSW-GP systems are the single-point fixings of the glass panels in combination with a conventional track rail profile. The design, featuring a highgrade stainless steel finish and the distinctive flush-mounted attachments, coordinates perfectly with contemporary architecture.



- Provide openness with transparency
- Enhance your functionality
- Ideal solutions for banks, shopping malls, galleries, and more
- Glass designs can be incorporated to provide a tailored look
- 1-year warranty



GLASS WALL SYSTEMS

SUSPENSION SYSTEM OPTIONS

G-330 TRACK & TROLLEY SYSTEM



- 2 year system warranty
- Aesthetic aluminum track
- Switch & Curve® technology facilitating effortless panel set-up
- All steel trolley body
- Ball bearing wheel assembly
- Vinyl trolley wheels
- Smooth & quiet operation

#17G TRACK & TROLLEY SYSTEM



- 5 year system warranty
- Durable steel track
- Switch & Curve® technology facilitating effortless panel set-up
- All steel trolley body
- Ball bearing wheel assembly
- Vinyl trolley wheels
- Smooth & quiet operation

MODERNFOLD GLASS WALL SYSTEMS

PRODUCT COMPARISON

MODEL	CONFIGURATION	HORIZONTAL RAIL	VERTICAL RAIL
COMPACTLINE	Single Panel	120 mm Contoured Rail	Optional
PUREVIEW PLUS	Single Panel	105 mm Square Rail w/ Carrier Profile	Optional
PUREVIEW PLUS	Paired Panel	105 mm Square Rail w/ Carrier Profile	N/A
PUREVIEW	Single Panel	105 mm Square Rail w/o Carrier Profile	Optional
PUREVIEW	Paired Panel	105 mm Square Rail w/o Carrier Profile	N/A
PUREVIEW PLUS / PUREVIEW FSW-G	Continuously Hinged Offset Stack	105 mm Square Rail	N/A
PUREVIEW PLUS / PUREVIEW FSW-C	Continuously Hinged Center Stack	105 mm Square Rail	N/A
362SR - DRS	Single Panel	3.62" Square Rail	Optional
362TR - DRS	Single Panel	3.62" Tapered Rail	Optional
600 SR - DRS	Single Panel	6" Square Rail	Optional
1000SR - DRS	Single Panel	10" Square Rail	Optional
HSW-GP	Single Panel	Patch Fittings	N/A

TRACK SYSTEM	STC	MAX HEIGHT	MAX WEIGHT	EGRESS TYPE	INTERIOR/ EXTERIOR
G-330 - 4" radius	15, 26	12'-0"	300 lbs	Pass Door & Pivot Panel	Int
G-330 - 4" radius	15, 33, 35, 37	12'-0"	330 lbs	Pass Door & Pivot Panel	Int
G-330	15	10'-0"	330 lbs	Pass Door & Pivot Panel	Int
G-330 - 4" radius	15, 33, 35, 37	12'-0"	330 lbs	Pivot Panel	Int
G-330	15	10'-0"	330 lbs	Pivot Panel	Int
G-330	15	10'-0"	176 lbs	Pivot Panel	Int
G-330	15	10'-0"	176 lbs	Pivot Panel	Int
17G - 4" radius G-330 - 4" radius	15, 18	12'-0"	330 lbs	Pivot Panel	Int
17G - 4" radius G-330 - 4" radius	15, 18	12'-0"	330 lbs	Pivot Panel	Int
17G - 4" radius G-330 - 4" radius	15, 18	12'-0"	330 lbs	Pivot Panel	Int
17G - 4" radius G-330 - 4" radius	15, 18	12'-0"	330 lbs	Pivot Panel	Int
G-330 - 4" radius	15	10'0"	220 lbs	Pivot Panel	Int



215 West New Road
Greenfield, IN 46140

Tel: 800-869-9685

Email: info@modernfold.com
Website: www.modernfold.com