



# PA 100

## TECH SHEET

---



# PA 100

---

PA 100 was developed according to the principles of modern partitioning. It is a versatile structure that allows for a wide range of finishes, modulation solutions to make it the perfect solution for unique and dynamic spaces.

It offers off-site construction, endless modularity and ease of installation, high acoustics and reusability.







# TECH DATA

## TYPE

Modular Opaque Wall

## PANELS

19mm ( $\frac{3}{4}$ ") MDF / Chipboard Panels finished in melamine, HPL or Wood Veneer

## MODULE TO MODULE CONNECTION

Line Systems Clip & Fix system

## TOLERANCE

10 to 20mm ( $\frac{3}{8}$ " to  $\frac{13}{16}$ ")

## MODULATION (HEIGHT)

46 dB version - up to 3500mm (11'6")

53 dB - up to 2800mm (9' 2  $\frac{1}{4}$ ")

## DOOR OPTIONS

50mm (2") Opaque Door | 10mm ( $\frac{3}{8}$ ") Single Glass Door | 50mm (2") Double Glazed Door | 50mm (2") Framed Single Glazed Door | Glass Skin Door

## ACOUSTIC PERFORMANCE

46 dB with 19mm ( $\frac{3}{4}$ ") panels and 40kg/m<sup>2</sup> (8.2 lbs/sq. ft.) rock wool

53 dB with 19mm ( $\frac{3}{4}$ ") panels, 75 kg/m<sup>2</sup> (15.3 lbs/sq. ft.) rock wool and MAD 4 membrane.







# DOORS

---



50MM(2'') DOUBLE GLAZED DOOR



50MM (2'') OPAQUE DOOR



GLASS SKIN DOOR

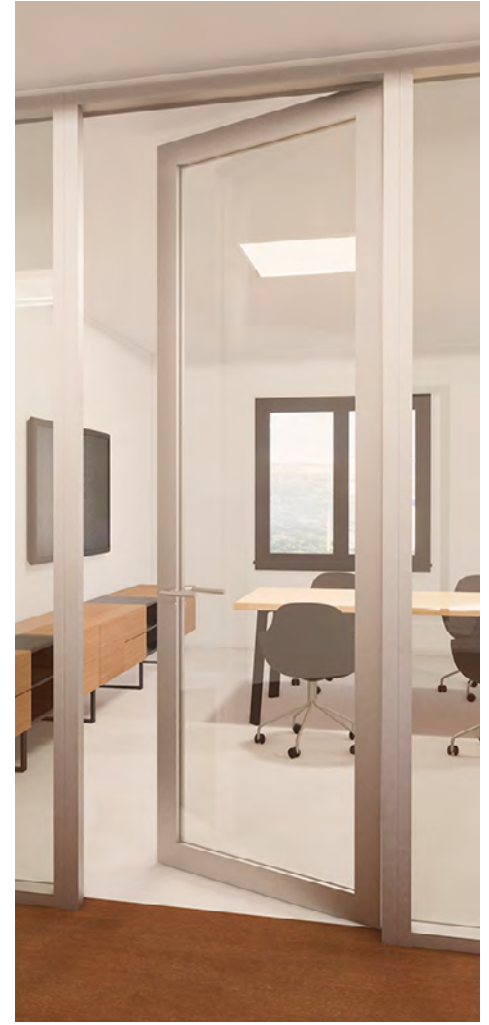

50MM (2'') FRAMED SINGLE GLASS DOOR

# TECHNICAL DETAILS

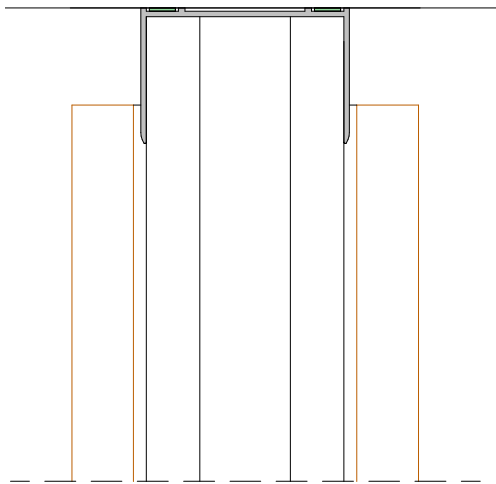

PA 100 OPAQUE CEILING DETAIL

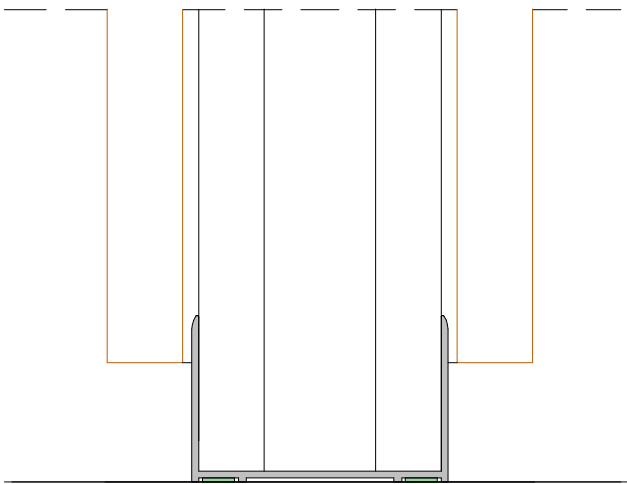

PA 100 OPAQUE FLOOR DETAIL

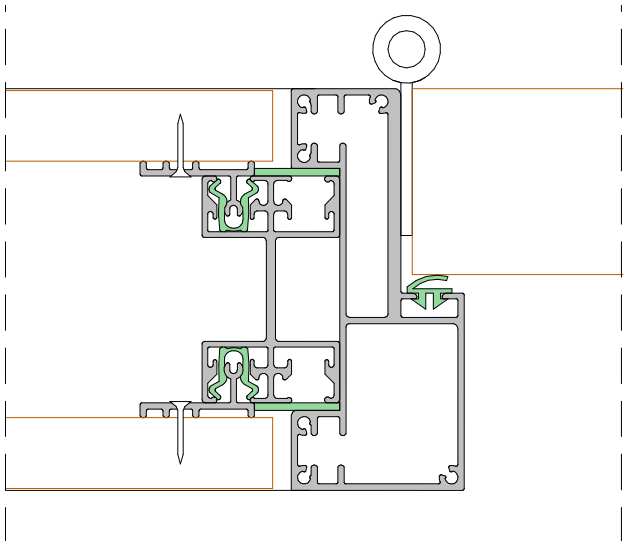

PA 100 OPAQUE CONNECTION TO 108MM (4 1/4")  
DOOR FRAME FOR 50MM (2") DOORS

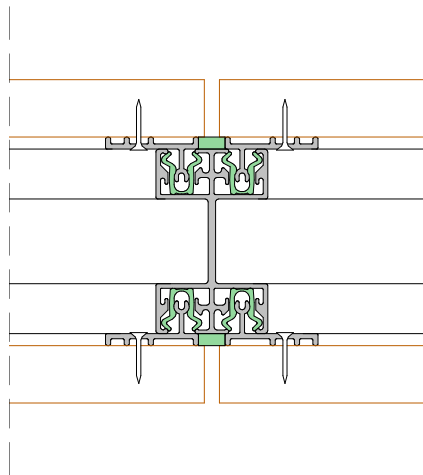

CLIP & FIX SYSTEM





[LINESYSTEMS.CA](http://LINESYSTEMS.CA)