



GLASS SKIN

TECH SHEET



GLASS SKIN

Glass Skin is an office partition of superior performance. Conceptualized for high-end projects where robustness and minimalism are both required.

It is a modular partition that gives the feeling that it is built only with glass, with no vertical profiles in sight. The Glass Skin was developed in order to enable an acoustic performance of 40 dB Rw and up to 49 dB Rw without compromising the aesthetics.





TECH DATA

TYPE

Modular Double Glazed Flush System

GLASS

6mm ($\frac{1}{4}$ ") and 8mm ($\frac{5}{16}$ ") (one on each side)

PROFILE DIMENSIONS

108mm ($4\frac{1}{4}$ ") x 33mm ($1\frac{5}{16}$ ") (w x h)

MODULE TO MODULE CONNECTION

Integrated 60mm x 30mm ($1\frac{3}{16}$ ") Steel Tube

TOLERANCE

10mm ($\frac{3}{8}$ ") to 20mm ($\frac{3}{4}$ ")

MODULATION (HEIGHT)

up to 3000mm (10') - more upon consultation

MODULATION (LENGTH)

between 200mm (8") and 1200mm (4') - more upon consultation

DOOR OPTIONS -

Glass Skin Door | Glass Skin Opaque Door |
Glass Skin Metal Door | 50mm (2") Double Glazed
Door | 50mm (2") Opaque Door

ACOUSTIC PERFORMANCE

a) 40 dB - 6mm ($\frac{1}{4}$ ") and 8mm ($\frac{5}{16}$ ") Tempered Glass

b) 49 dB - 6mm ($\frac{1}{4}$ ") and 8mm ($\frac{5}{16}$ ") Acoustic
Laminated Glass



SWING DOORS



GLASS SKIN DOOR



50MM (2") DOUBLE GLAZED DOOR



OPAQUE DOOR

TECHNICAL DETAILS

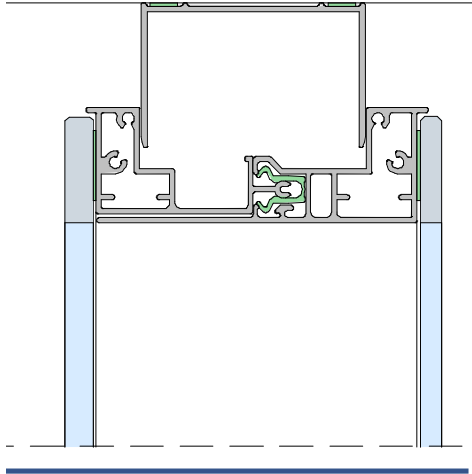

GLASS SKIN CEILING CONNECTION

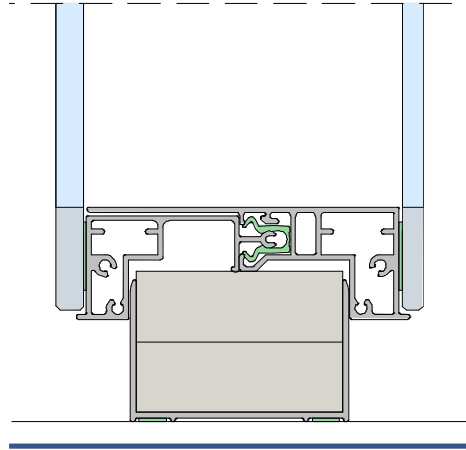

GLASS SKIN FLOOR CONNECTION

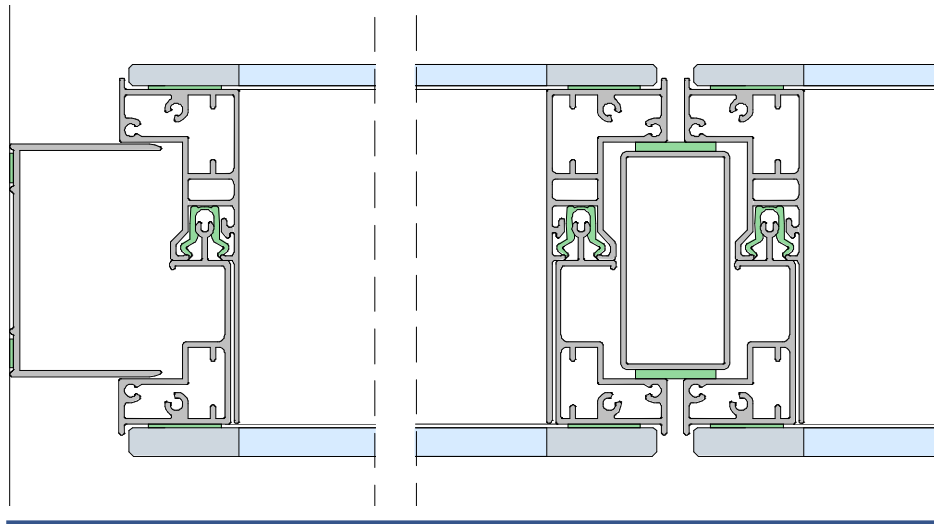

GLASS SKIN MODULE-TO-MODULE & WALL CONNECTION

TECHNICAL DETAILS

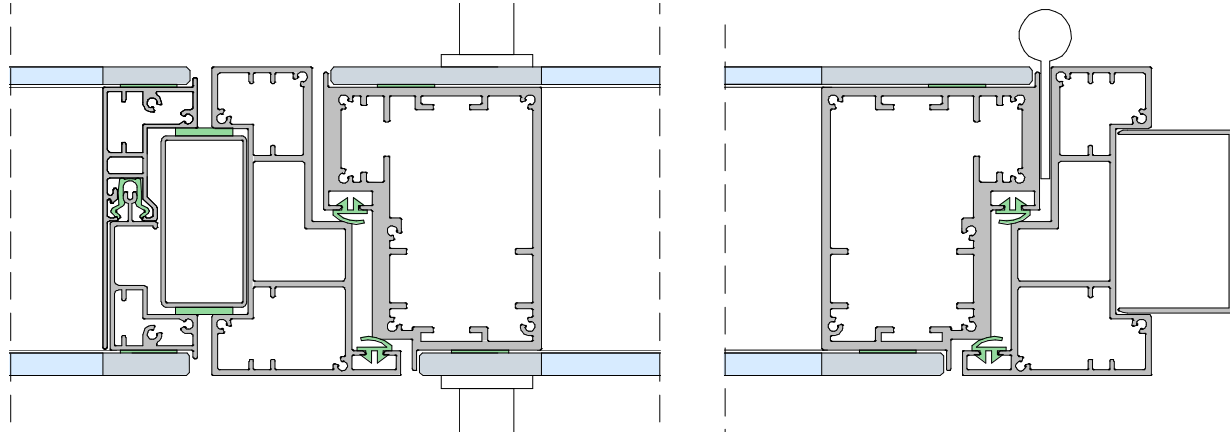

GLASS SKIN DOOR TO GLASS SKIN MODULE CONNECTION

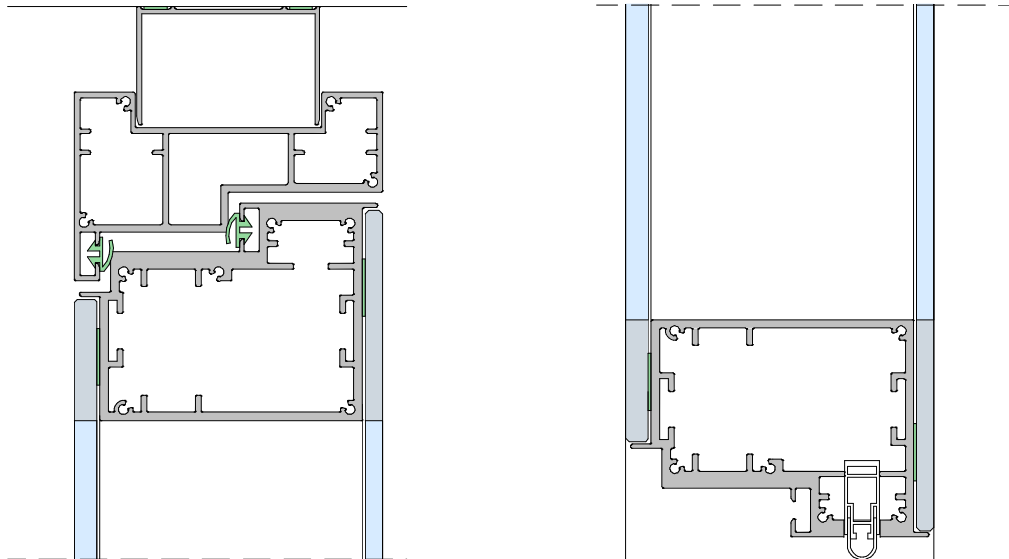

GLASS SKIN DOOR VERTICAL CUT





LINESYSTEMS.CA